

# How to replace your hearing aid tubing

1

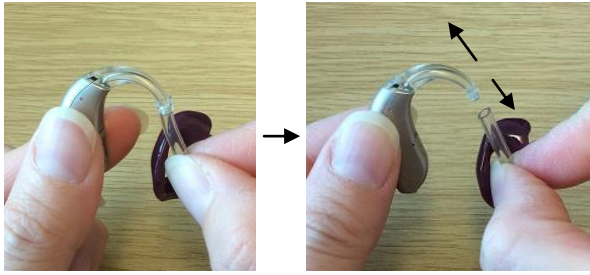

Pull the hearing aid off of the tubing.

2

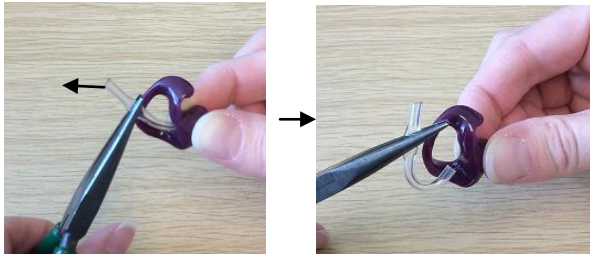

Pull the tubing out of the ear mould. It may help to use pliers. Keep the old tubing until you have finished.

3

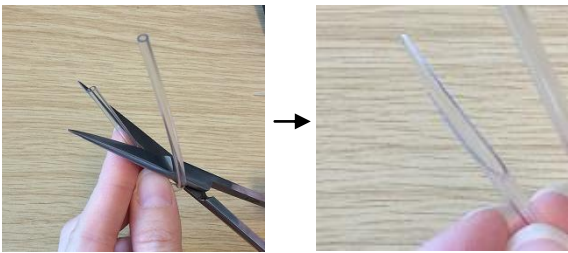

Using new tubing, cut one end to make a point.

4

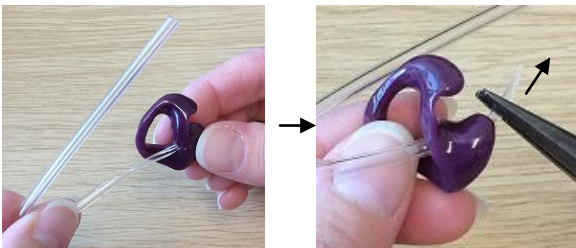

Thread the tubing through the hole in the ear mould. The tubing point should come out of the smaller end.

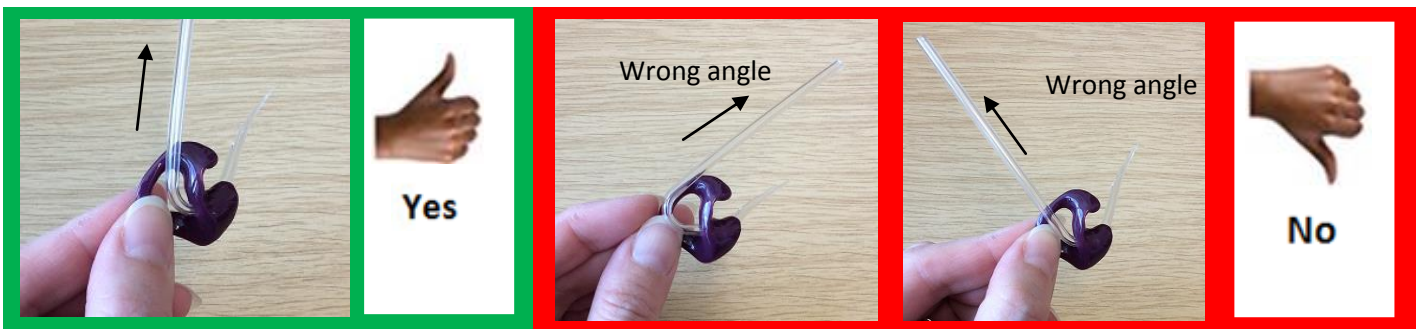

5



Cut off the pointed end of the tube using a sharp knife or scissors.

